

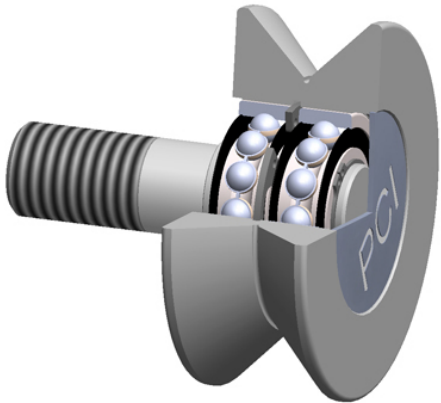

## Sealmaster BEARING LTD



### PCI Procal Inc. VTR-2.50 V-Groove Cam Followers

Bearing No. VTR-2.50

roller diameter:	2.5000 in
roller material:	Chrome Steel
roller width:	1.3125 in
bearing element:	Balls - Two Rows
point diameter:	1.5000 in
closure type:	Double Seal
stud diameter:	0.7500 in
radial dynamic load capacity:	2750 lb
thread size:	3/4-16
radial static load capacity:	1394 lb
stud length:	1.7500 in
technical specifications:	<a href="#">Click here</a>
roller shape:	V-Grooved

VTR-2.50 Bearing 2D drawings and 3D CAD models