

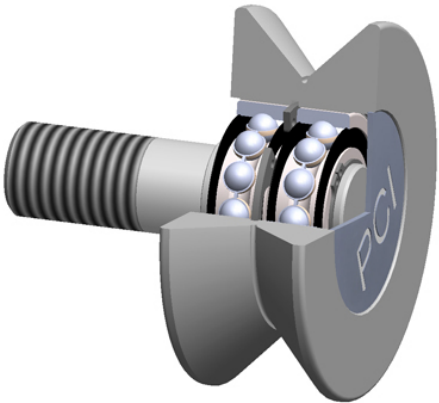

## Sealmaster BEARING LTD



### PCI Procal Inc. VTR-1.50 V-Groove Cam Followers

Bearing No. VTR-1.50

roller diameter:	1.5000 in
roller material:	Chrome Steel
roller width:	0.7500 in
bearing element:	Balls - Two Rows
point diameter:	1.1250 in
closure type:	Double Seal
stud diameter:	0.4375 in
radial dynamic load capacity:	627 lb
thread size:	7/16-20
radial static load capacity:	278 lb
stud length:	1.0000 in
technical specifications:	<a href="#">Click here</a>
roller shape:	V-Grooved

VTR-1.50 Bearing 2D drawings and 3D CAD models