

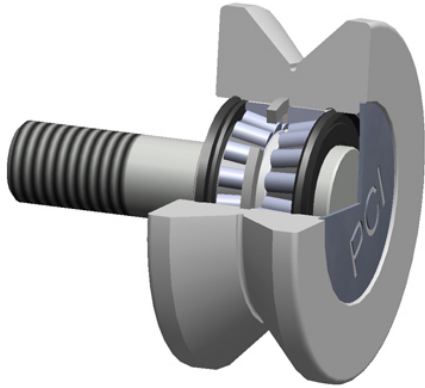

Sealmaster BEARING LTD



PCI Procal Inc. VTR-6.50 V-Groove Cam Followers

Bearing No. VTR-6.50

roller diameter:	6.5000 in
roller material:	Chrome Steel
roller width:	3.0000 in
bearing element:	Tapered Rollers
point diameter:	5.0000 in
closure type:	Double Seal
stud diameter:	2.0000 in
radial dynamic load capacity:	35870 lb
thread size:	2-12
radial static load capacity:	58400 lb
stud length:	4.5000 in
technical specifications:	Click here
roller shape:	V-Grooved

VTR-6.50 Bearing 2D drawings and 3D CAD models